

Manifolds with Eurokonus or flat faced connection **12**

Thermo-electric manifolds	297
Set point regulating unit	306
Modulating regulating unit	310
Thermo-electric actuators, Chrono-thermostats, Thermostats	312
Accessories for thermo-electric manifolds	313
Intermediate connections	314
MULTIFAR manifolds for domestic services and heating systems	317
Distribution manifolds	319
Plugs and reductions for manifolds	321
SIMPLYFAR extensible joint	322
Fittings with eurokonus connection	323
Adapters and sealing kit	324

MANIFOLDS SUITABLE FOR THERMO-ELECTRIC ACTUATORS – RETURN CIRCUIT

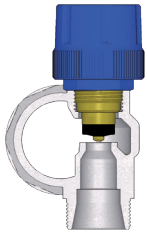

The special shape of FAR manifolds facilitates high flow rates by reducing flow resistance. This special feature permits optimum choice of manifold diameter in relation to the number of circuits to be connected.

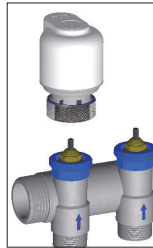

Thermo-electric actuator installation

Screw the thermo-electric actuator by hand and tighten the ring.

Do not use plumbing wrenches, tongs or other similar tools.

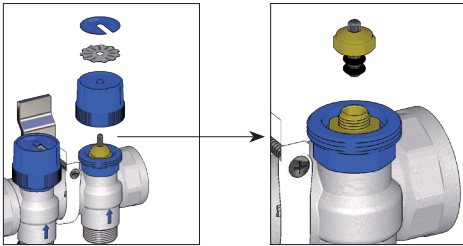

The return manifolds is equipped with a blue handle and two silk-screen printed discs for circuit identification. A thermo-electric actuator can be fixed to the manifold once the blue handle is removed. Thanks to the simple safety system, it is possible to replace the double O-ring seal of the body, without any need to drain the system.

MANIFOLDS WITH LOCKSHIELD VALVES OR FLOWMETERS - SUPPLY CIRCUIT

The supply manifold is equipped with a micrometric regulation system, with which it is possible to regulate or shut off flow within the system.

FAR offers two different versions:

- one provided with flowmeters for flow-rate control
- one provided with a new balancing body

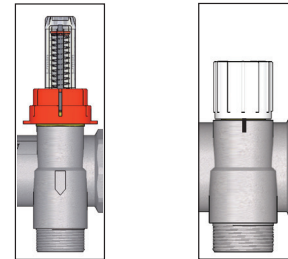

BALANCING LOCKSHIELD VALVES

Adjustment is carried out by means of the handle indicating the reference numbers. The handle stroke is less than 360° and ranges between position 0 (lockshield valve fully closed) and 5.5 (lockshield valve fully open). The handle position is easily identified by the reference notches on the manifold.

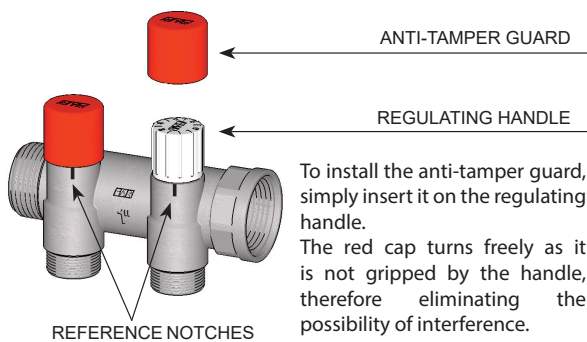

FLOWMETERS

To fully open and then balance the flowmeters, remove the anti-tampering device and turn the regulating valve clockwise to decrease flow, or counterclockwise to increase it (picture No. 1). Once balancing has been completed, lock the flowmeter again with the anti-tampering device (picture No. 2).

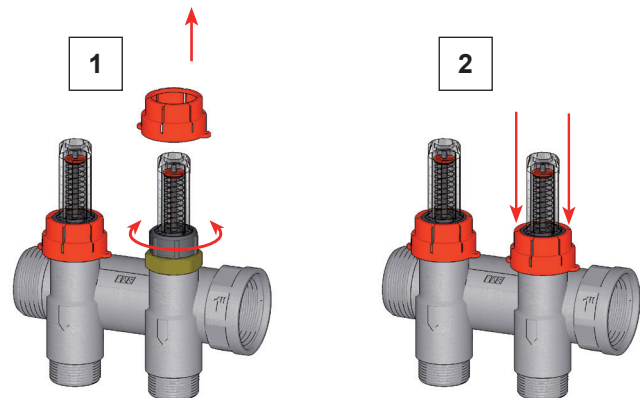

ADAPTERS

With the aid of the appropriate sealing kit it is possible to connect a variety of types of pipe to the manifolds using EUROKONUS adapters.



Art. 6076 - Adapter for multilayer pipe



Art. 6075 - Adapter for plastic pipe

12 THERMO-ELECTRIC MANIFOLDS

Chrome-plated brass FLANGED modular return manifold.

- Body made of CB753S brass
- Built-in shut-off valves suitable for thermo-electric actuators
- Screws and O-rings for connection
- Connection: 1" female-female
- Outlets: 3/4" male EUROKONUS
- Centre distance between ports: mm.50



ART. 3917



Code	outlets	size	€	box
3917 13402	2	1"x3/4"		1
3917 13403	3	1"x3/4"		1
3917 13404	4	1"x3/4"		1
3917 13405	5	1"x3/4"		1
3917 13406	6	1"x3/4"		1
3917 13407	7	1"x3/4"		1
3917 13408	8	1"x3/4"		1
3917 13409	9	1"x3/4"		1
3917 13410	10	1"x3/4"		1
3917 13411	11	1"x3/4"		1
3917 13412	12	1"x3/4"		1

Chrome-plated brass FLANGED modular delivery manifold.

- Body made of CB753S brass
- Built-in balancing lockshield valves
- Screws and O-rings for connection
- Connection: 1" female-female
- Outlets: 3/4" male EUROKONUS
- Centre distance between ports: mm.50
- **Patented**



ART. 3918



Code	outlets	size	€	box
3918 13402	2	1"x3/4"		1
3918 13403	3	1"x3/4"		1
3918 13404	4	1"x3/4"		1
3918 13405	5	1"x3/4"		1
3918 13406	6	1"x3/4"		1
3918 13407	7	1"x3/4"		1
3918 13408	8	1"x3/4"		1
3918 13409	9	1"x3/4"		1
3918 13410	10	1"x3/4"		1
3918 13411	11	1"x3/4"		1
3918 13412	12	1"x3/4"		1

Chrome-plated brass FLANGED modular delivery manifold.

- Body made of CB753S brass
- Flowmeters and flow-rate balancing valves
- Screws and O-rings for connection
- Connection: 1" female-female
- Outlets: 3/4" male EUROKONUS
- Flowmeters range: 0-5 l/min
- Centre distance between ports: mm.50



ART. 3982



Code	outlets	size	€	box
3982 13402	2	1"x3/4"		1
3982 13403	3	1"x3/4"		1
3982 13404	4	1"x3/4"		1
3982 13405	5	1"x3/4"		1
3982 13406	6	1"x3/4"		1
3982 13407	7	1"x3/4"		1
3982 13408	8	1"x3/4"		1
3982 13409	9	1"x3/4"		1
3982 13410	10	1"x3/4"		1
3982 13411	11	1"x3/4"		1
3982 13412	12	1"x3/4"		1

PRE-ASSEMBLED chrome-plated brass FLANGED manifold complete with:

- Delivery manifold with built-in balancing lockshield valves
- Return manifold with built-in shut-off valves suitable for thermo-electric actuators
- Fixing brackets, art. 7480
- Screws and O-rings for connection
- Connection: 1" female-female
- Outlets: 3/4" male EUROKONUS
- Centre distance between ports: mm.50

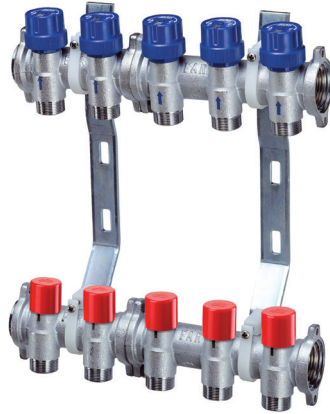

ART. 3919

Code	outlets	size	€	box
3919 13402	2	1"x3/4"		1
3919 13403	3	1"x3/4"		1
3919 13404	4	1"x3/4"		1
3919 13405	5	1"x3/4"		1
3919 13406	6	1"x3/4"		1
3919 13407	7	1"x3/4"		1
3919 13408	8	1"x3/4"		1
3919 13409	9	1"x3/4"		1
3919 13410	10	1"x3/4"		1
3919 13411	11	1"x3/4"		1
3919 13412	12	1"x3/4"		1

PRE-ASSEMBLED chrome-plated brass FLANGED manifold complete with:

- Delivery manifold with flowmeters and flow-rate balancing valves
- Return manifold with built-in shut-off valves suitable for thermo-electric actuators
- Fixing brackets, art. 7480
- Screws and O-rings for connection
- Connection: 1" female-female
- Outlets: 3/4" male EUROKONUS
- Flowmeters range: 0-5 l/min
- Centre distance between ports: mm.50



ART. 3983

Code	outlets	size	€	box
3983 13402	2	1"x3/4"		1
3983 13403	3	1"x3/4"		1
3983 13404	4	1"x3/4"		1
3983 13405	5	1"x3/4"		1
3983 13406	6	1"x3/4"		1
3983 13407	7	1"x3/4"		1
3983 13408	8	1"x3/4"		1
3983 13409	9	1"x3/4"		1
3983 13410	10	1"x3/4"		1
3983 13411	11	1"x3/4"		1
3983 13412	12	1"x3/4"		1

12 THERMO-ELECTRIC MANIFOLDS

- Chrome-plated brass FLANGED modular manifold complete with:
- Return manifold with built-in shut-off valves suitable for thermo-electric actuators
 - Intermediate connection, art. 3445
 - Screws and O-rings for connection
 - Connection: 1" female-female
 - Outlets: 3/4" male EUROKONUS
 - Centre distance between ports: mm.50



ART. 3469



Code	outlets	size	€	box
3469 13404	4	1"x3/4"		1
3469 13405	5	1"x3/4"		1
3469 13406	6	1"x3/4"		1
3469 13407	7	1"x3/4"		1
3469 13408	8	1"x3/4"		1
3469 13409	9	1"x3/4"		1
3469 13410	10	1"x3/4"		1
3469 13411	11	1"x3/4"		1
3469 13412	12	1"x3/4"		1

- Chrome-plated brass FLANGED modular manifold complete with:
- Delivery manifold with built-in balancing lockshield valves
 - Intermediate connection, art. 3445

- Screws and O-rings for connection
- Connection: 1" female-female
- Outlets: 3/4" male EUROKONUS
- Centre distance between ports: mm.50
- Patented

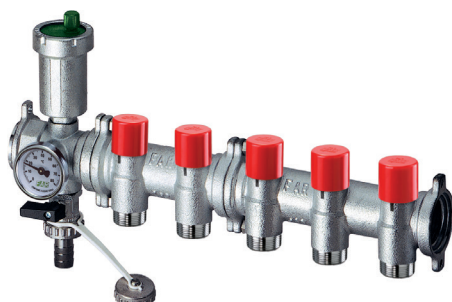

ART. 3470



Code	outlets	size	€	box
3470 13404	4	1"x3/4"		1
3470 13405	5	1"x3/4"		1
3470 13406	6	1"x3/4"		1
3470 13407	7	1"x3/4"		1
3470 13408	8	1"x3/4"		1
3470 13409	9	1"x3/4"		1
3470 13410	10	1"x3/4"		1
3470 13411	11	1"x3/4"		1
3470 13412	12	1"x3/4"		1

- Chrome-plated brass FLANGED modular manifold complete with:
- Delivery manifold with flowmeters and flow-rate balancing valves
 - Intermediate connection, art. 3445

- Screws and O-rings for connection
- Connection: 1" female-female
- Outlets: 3/4" male EUROKONUS
- Flowmeters range: 0-5 l/min
- Centre distance between ports: mm.50

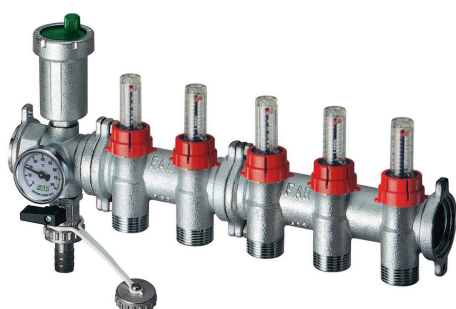

ART. 3582



Code	outlets	size	€	box
3582 13404	4	1"x3/4"		1
3582 13405	5	1"x3/4"		1
3582 13406	6	1"x3/4"		1
3582 13407	7	1"x3/4"		1
3582 13408	8	1"x3/4"		1
3582 13409	9	1"x3/4"		1
3582 13410	10	1"x3/4"		1
3582 13411	11	1"x3/4"		1
3582 13412	12	1"x3/4"		1

PRE-ASSEMBLED chrome-plated brass FLANGED manifold complete with:

- Delivery manifold with built-in balancing lockshield valves
- Return manifold with built-in shut-off valves suitable for thermo-electric actuators
- Intermediate connections, art. 3445
- Fixing brackets, art. 7480
- Screws and O-rings for connection
- Connection: 1" female-female
- Outlets: 3/4" male EUROKONUS
- Centre distance between ports: mm.50

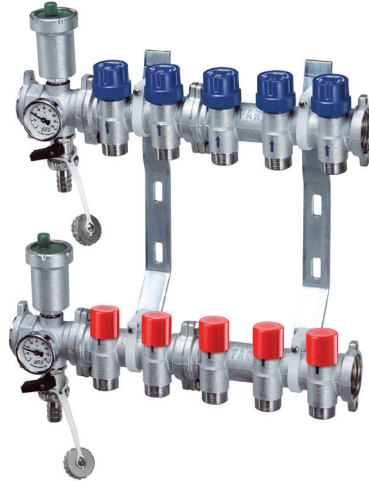

ART. 3471

Code	outlets	size	€	box
3471 13404	4	1"x3/4"		1
3471 13405	5	1"x3/4"		1
3471 13406	6	1"x3/4"		1
3471 13407	7	1"x3/4"		1
3471 13408	8	1"x3/4"		1
3471 13409	9	1"x3/4"		1
3471 13410	10	1"x3/4"		1
3471 13411	11	1"x3/4"		1
3471 13412	12	1"x3/4"		1

PRE-ASSEMBLED chrome-plated brass FLANGED manifold complete with:

- Delivery manifold with flowmeters and flow-rate balancing valves
- Return manifold with built-in shut-off valves suitable for thermo-electric actuators
- Intermediate connections, art. 3445
- Fixing brackets, art. 7480
- Screws and O-rings for connection
- Connection: 1" female-female
- Outlets: 3/4" male EUROKONUS
- Flowmeters range: 0-5 l/min
- Centre distance between ports: mm.50



ART. 3583

Code	outlets	size	€	box
3583 13404	4	1"x3/4"		1
3583 13405	5	1"x3/4"		1
3583 13406	6	1"x3/4"		1
3583 13407	7	1"x3/4"		1
3583 13408	8	1"x3/4"		1
3583 13409	9	1"x3/4"		1
3583 13410	10	1"x3/4"		1
3583 13411	11	1"x3/4"		1
3583 13412	12	1"x3/4"		1



- Chrome-plated modular return manifold in CB753S brass.
- Built-in shut-off valves suitable for thermo-electric actuators
 - Connection: 1" – 1 1/4" male-female
 - Outlets: 1/2"-3/4" male EUROKONUS
 - Centre distance between ports: mm.50

ART. 3911

Code	outlets	size	€	box	Code	outlets	size	€	box	Code	outlets	size	€	box
3911 11202	2	1"x1/2"		1	3911 13402	2	1"x3/4"		1	3911 1143402	2	1"1/4x3/4"		1
3911 11203	3	1"x1/2"		1	3911 13403	3	1"x3/4"		1	3911 1143403	3	1"1/4x3/4"		1
3911 11204	4	1"x1/2"		1	3911 13404	4	1"x3/4"		1	3911 1143404	4	1"1/4x3/4"		1
3911 11205	5	1"x1/2"		1	3911 13405	5	1"x3/4"		1	3911 1143405	5	1"1/4x3/4"		1
3911 11206	6	1"x1/2"		1	3911 13406	6	1"x3/4"		1	3911 1143406	6	1"1/4x3/4"		1
3911 11207	7	1"x1/2"		1	3911 13407	7	1"x3/4"		1	3911 1143407	7	1"1/4x3/4"		1
3911 11208	8	1"x1/2"		1	3911 13408	8	1"x3/4"		1	3911 1143408	8	1"1/4x3/4"		1
3911 11209	9	1"x1/2"		1	3911 13409	9	1"x3/4"		1	3911 1143409	9	1"1/4x3/4"		1
3911 11210	10	1"x1/2"		1	3911 13410	10	1"x3/4"		1	3911 1143410	10	1"1/4x3/4"		1
3911 11211	11	1"x1/2"		1	3911 13411	11	1"x3/4"		1	3911 1143411	11	1"1/4x3/4"		1
3911 11212	12	1"x1/2"		1	3911 13412	12	1"x3/4"		1	3911 1143412	12	1"1/4x3/4"		1



- Chrome-plated modular delivery manifold in CB753S brass.
- Built-in balancing lockshield valves
 - Connection: 1" – 1 1/4" male-female
 - Outlets: 1/2"-3/4" male EUROKONUS
 - Centre distance between ports: mm.50
 - **Patented**

ART. 3921

Code	outlets	size	€	box	Code	outlets	size	€	box	Code	outlets	size	€	box
3921 11202	2	1"x1/2"		1	3921 13402	2	1"x3/4"		1	3921 1143402	2	1"1/4x3/4"		1
3921 11203	3	1"x1/2"		1	3921 13403	3	1"x3/4"		1	3921 1143403	3	1"1/4x3/4"		1
3921 11204	4	1"x1/2"		1	3921 13404	4	1"x3/4"		1	3921 1143404	4	1"1/4x3/4"		1
3921 11205	5	1"x1/2"		1	3921 13405	5	1"x3/4"		1	3921 1143405	5	1"1/4x3/4"		1
3921 11206	6	1"x1/2"		1	3921 13406	6	1"x3/4"		1	3921 1143406	6	1"1/4x3/4"		1
3921 11207	7	1"x1/2"		1	3921 13407	7	1"x3/4"		1	3921 1143407	7	1"1/4x3/4"		1
3921 11208	8	1"x1/2"		1	3921 13408	8	1"x3/4"		1	3921 1143408	8	1"1/4x3/4"		1
3921 11209	9	1"x1/2"		1	3921 13409	9	1"x3/4"		1	3921 1143409	9	1"1/4x3/4"		1
3921 11210	10	1"x1/2"		1	3921 13410	10	1"x3/4"		1	3921 1143410	10	1"1/4x3/4"		1
3921 11211	11	1"x1/2"		1	3921 13411	11	1"x3/4"		1	3921 1143411	11	1"1/4x3/4"		1
3921 11212	12	1"x1/2"		1	3921 13412	12	1"x3/4"		1	3921 1143412	12	1"1/4x3/4"		1



- Chrome-plated modular delivery manifold in CB753S brass.
- Flowmeters and flow-rate balancing valves
 - Connection: 1" – 1 1/4" male-female
 - Outlets: 1/2"-3/4" male EUROKONUS
 - Flowmeters range: 0-5 l/min
 - Centre distance between ports: mm.50

ART. 3980

Code	outlets	size	€	box	Code	outlets	size	€	box	Code	outlets	size	€	box
3980 11202	2	1"x1/2"		1	3980 13402	2	1"x3/4"		1	3980 1143402	2	1"1/4x3/4"		1
3980 11203	3	1"x1/2"		1	3980 13403	3	1"x3/4"		1	3980 1143403	3	1"1/4x3/4"		1
3980 11204	4	1"x1/2"		1	3980 13404	4	1"x3/4"		1	3980 1143404	4	1"1/4x3/4"		1
3980 11205	5	1"x1/2"		1	3980 13405	5	1"x3/4"		1	3980 1143405	5	1"1/4x3/4"		1
3980 11206	6	1"x1/2"		1	3980 13406	6	1"x3/4"		1	3980 1143406	6	1"1/4x3/4"		1
3980 11207	7	1"x1/2"		1	3980 13407	7	1"x3/4"		1	3980 1143407	7	1"1/4x3/4"		1
3980 11208	8	1"x1/2"		1	3980 13408	8	1"x3/4"		1	3980 1143408	8	1"1/4x3/4"		1
3980 11209	9	1"x1/2"		1	3980 13409	9	1"x3/4"		1	3980 1143409	9	1"1/4x3/4"		1
3980 11210	10	1"x1/2"		1	3980 13410	10	1"x3/4"		1	3980 1143410	10	1"1/4x3/4"		1
3980 11211	11	1"x1/2"		1	3980 13411	11	1"x3/4"		1	3980 1143411	11	1"1/4x3/4"		1
3980 11212	12	1"x1/2"		1	3980 13412	12	1"x3/4"		1	3980 1143412	12	1"1/4x3/4"		1

PRE-ASSEMBLED chrome-plated brass manifold complete with:

- Delivery manifold with built-in balancing lockshield valves
- Return manifold with built-in shut-off valves suitable for thermo-electric actuators
- Fixing brackets, art. 7480
- Connection: 1"-1 1/4" male-female
- Outlets: 1/2"-3/4" male EUROKONUS
- Centre distance between ports: mm.50

ART. 3928



Code	outlets	size	€	box
3928 11202	2	1"x1/2"		1
3928 11203	3	1"x1/2"		1
3928 11204	4	1"x1/2"		1
3928 11205	5	1"x1/2"		1
3928 11206	6	1"x1/2"		1
3928 11207	7	1"x1/2"		1
3928 11208	8	1"x1/2"		1
3928 11209	9	1"x1/2"		1
3928 11210	10	1"x1/2"		1
3928 11211	11	1"x1/2"		1
3928 11212	12	1"x1/2"		1



Code	outlets	size	€	box
3928 13402	2	1"x3/4"		1
3928 13403	3	1"x3/4"		1
3928 13404	4	1"x3/4"		1
3928 13405	5	1"x3/4"		1
3928 13406	6	1"x3/4"		1
3928 13407	7	1"x3/4"		1
3928 13408	8	1"x3/4"		1
3928 13409	9	1"x3/4"		1
3928 13410	10	1"x3/4"		1
3928 13411	11	1"x3/4"		1
3928 13412	12	1"x3/4"		1
3928 1143402	2	1"1/4x3/4"		1
3928 1143403	3	1"1/4x3/4"		1
3928 1143404	4	1"1/4x3/4"		1
3928 1143405	5	1"1/4x3/4"		1
3928 1143406	6	1"1/4x3/4"		1
3928 1143407	7	1"1/4x3/4"		1
3928 1143408	8	1"1/4x3/4"		1
3928 1143409	9	1"1/4x3/4"		1
3928 1143410	10	1"1/4x3/4"		1
3928 1143411	11	1"1/4x3/4"		1
3928 1143412	12	1"1/4x3/4"		1

PRE-ASSEMBLED chrome-plated brass manifold complete with:

- Delivery manifold with flowmeters and flow-rate balancing valves
- Return manifold with built-in shut-off valves suitable for thermo-electric actuators
- Fixing brackets, art. 7480
- Connection: 1" - 1 1/4" male-female
- Outlets: 1/2"-3/4" male EUROKONUS
- Flowmeters range: 0-5 l/min
- Centre distance between ports: mm.50

ART. 3981



Code	outlets	size	€	box
3981 11202	2	1"x1/2"		1
3981 11203	3	1"x1/2"		1
3981 11204	4	1"x1/2"		1
3981 11205	5	1"x1/2"		1
3981 11206	6	1"x1/2"		1
3981 11207	7	1"x1/2"		1
3981 11208	8	1"x1/2"		1
3981 11209	9	1"x1/2"		1
3981 11210	10	1"x1/2"		1
3981 11211	11	1"x1/2"		1
3981 11212	12	1"x1/2"		1



Code	outlets	size	€	box
3981 13402	2	1"x3/4"		1
3981 13403	3	1"x3/4"		1
3981 13404	4	1"x3/4"		1
3981 13405	5	1"x3/4"		1
3981 13406	6	1"x3/4"		1
3981 13407	7	1"x3/4"		1
3981 13408	8	1"x3/4"		1
3981 13409	9	1"x3/4"		1
3981 13410	10	1"x3/4"		1
3981 13411	11	1"x3/4"		1
3981 13412	12	1"x3/4"		1
3981 1143402	2	1"1/4x3/4"		1
3981 1143403	3	1"1/4x3/4"		1
3981 1143404	4	1"1/4x3/4"		1
3981 1143405	5	1"1/4x3/4"		1
3981 1143406	6	1"1/4x3/4"		1
3981 1143407	7	1"1/4x3/4"		1
3981 1143408	8	1"1/4x3/4"		1
3981 1143409	9	1"1/4x3/4"		1
3981 1143410	10	1"1/4x3/4"		1
3981 1143411	11	1"1/4x3/4"		1
3981 1143412	12	1"1/4x3/4"		1

12 THERMO-ELECTRIC MANIFOLDS

- Chrome-plated brass modular manifold complete with:
- Return manifold with built-in shut-off valves suitable for thermo-electric actuators
 - Intermediate connection, art. 3438
 - Connection: 1" – 1"1/4 female-female
 - Outlets: 1/2"-3/4" male EUROKONUS
 - Centre distance between ports: mm.50



ART. 3466



Code	outlets	size	€	box
3466 11204	4	1"x1/2"		1
3466 11205	5	1"x1/2"		1
3466 11206	6	1"x1/2"		1
3466 11207	7	1"x1/2"		1
3466 11208	8	1"x1/2"		1
3466 11209	9	1"x1/2"		1
3466 11210	10	1"x1/2"		1
3466 11211	11	1"x1/2"		1
3466 11212	12	1"x1/2"		1

Code	outlets	size	€	box
3466 13404	4	1"x3/4"		1
3466 13405	5	1"x3/4"		1
3466 13406	6	1"x3/4"		1
3466 13407	7	1"x3/4"		1
3466 13408	8	1"x3/4"		1
3466 13409	9	1"x3/4"		1
3466 13410	10	1"x3/4"		1
3466 13411	11	1"x3/4"		1
3466 13412	12	1"x3/4"		1

Code	outlets	size	€	box
3466 1143404	4	1"1/4x3/4"		1
3466 1143405	5	1"1/4x3/4"		1
3466 1143406	6	1"1/4x3/4"		1
3466 1143407	7	1"1/4x3/4"		1
3466 1143408	8	1"1/4x3/4"		1
3466 1143409	9	1"1/4x3/4"		1
3466 1143410	10	1"1/4x3/4"		1
3466 1143411	11	1"1/4x3/4"		1
3466 1143412	12	1"1/4x3/4"		1

- Chrome-plated brass modular manifold complete with:
- Delivery manifold with built-in balancing lockshield valves
 - Intermediate connection, art. 3438

- Connection: 1" – 1"1/4 female-female
- Outlets: 1/2"-3/4" male EUROKONUS
- Centre distance between ports: mm.50
- Patented

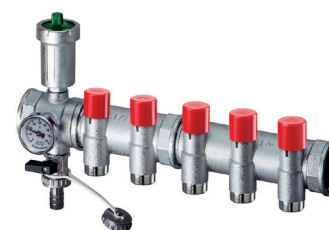

ART. 3467



Code	outlets	size	€	box
3467 11204	4	1"x1/2"		1
3467 11205	5	1"x1/2"		1
3467 11206	6	1"x1/2"		1
3467 11207	7	1"x1/2"		1
3467 11208	8	1"x1/2"		1
3467 11209	9	1"x1/2"		1
3467 11210	10	1"x1/2"		1
3467 11211	11	1"x1/2"		1
3467 11212	12	1"x1/2"		1

Code	outlets	size	€	box
3467 13404	4	1"x3/4"		1
3467 13405	5	1"x3/4"		1
3467 13406	6	1"x3/4"		1
3467 13407	7	1"x3/4"		1
3467 13408	8	1"x3/4"		1
3467 13409	9	1"x3/4"		1
3467 13410	10	1"x3/4"		1
3467 13411	11	1"x3/4"		1
3467 13412	12	1"x3/4"		1

Code	outlets	size	€	box
3467 1143404	4	1"1/4x3/4"		1
3467 1143405	5	1"1/4x3/4"		1
3467 1143406	6	1"1/4x3/4"		1
3467 1143407	7	1"1/4x3/4"		1
3467 1143408	8	1"1/4x3/4"		1
3467 1143409	9	1"1/4x3/4"		1
3467 1143410	10	1"1/4x3/4"		1
3467 1143411	11	1"1/4x3/4"		1
3467 1143412	12	1"1/4x3/4"		1

- Chrome-plated brass modular manifold complete with:
- Delivery manifold with flowmeters and flow-rate balancing valves
 - Intermediate connection, art. 3438

- Connection: 1"-1"1/4 female-female
- Outlets: 1/2"-3/4" male EUROKONUS
- Flowmeters range: 0-5 l/min
- Centre distance between ports: mm.50

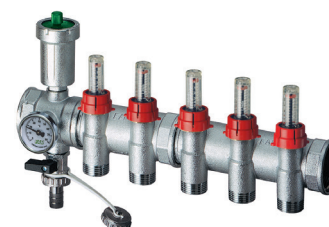

ART. 3580



Code	outlets	size	€	box
3580 11204	4	1"x1/2"		1
3580 11205	5	1"x1/2"		1
3580 11206	6	1"x1/2"		1
3580 11207	7	1"x1/2"		1
3580 11208	8	1"x1/2"		1
3580 11209	9	1"x1/2"		1
3580 11210	10	1"x1/2"		1
3580 11211	11	1"x1/2"		1
3580 11212	12	1"x1/2"		1

Code	outlets	size	€	box
3580 13404	4	1"x3/4"		1
3580 13405	5	1"x3/4"		1
3580 13406	6	1"x3/4"		1
3580 13407	7	1"x3/4"		1
3580 13408	8	1"x3/4"		1
3580 13409	9	1"x3/4"		1
3580 13410	10	1"x3/4"		1
3580 13411	11	1"x3/4"		1
3580 13412	12	1"x3/4"		1

Code	outlets	size	€	box
3580 1143404	4	1"1/4x3/4"		1
3580 1143405	5	1"1/4x3/4"		1
3580 1143406	6	1"1/4x3/4"		1
3580 1143407	7	1"1/4x3/4"		1
3580 1143408	8	1"1/4x3/4"		1
3580 1143409	9	1"1/4x3/4"		1
3580 1143410	10	1"1/4x3/4"		1
3580 1143411	11	1"1/4x3/4"		1
3580 1143412	12	1"1/4x3/4"		1

PRE-ASSEMBLED chrome-plated brass manifold complete with:

- Delivery manifold with built-in balancing lockshield valves
- Return manifold with built-in shut-off valves suitable for thermo-electric actuators
- Intermediate connections, art. 3438
- Fixing brackets, art. 7480
- Connection: 1"-1 1/4" female-female
- Outlets: 1/2"-3/4" male EUROKONUS
- Centre distance between ports: mm.50



ART. 3468

Code	outlets	size	€	box
3468 11204	4	1"x1/2"		1
3468 11205	5	1"x1/2"		1
3468 11206	6	1"x1/2"		1
3468 11207	7	1"x1/2"		1
3468 11208	8	1"x1/2"		1
3468 11209	9	1"x1/2"		1
3468 11210	10	1"x1/2"		1
3468 11211	11	1"x1/2"		1
3468 11212	12	1"x1/2"		1



Code	outlets	size	€	box
3468 13404	4	1"x3/4"		1
3468 13405	5	1"x3/4"		1
3468 13406	6	1"x3/4"		1
3468 13407	7	1"x3/4"		1
3468 13408	8	1"x3/4"		1
3468 13409	9	1"x3/4"		1
3468 13410	10	1"x3/4"		1
3468 13411	11	1"x3/4"		1
3468 13412	12	1"x3/4"		1
3468 1143404	4	1"1/4x3/4"		1
3468 1143405	5	1"1/4x3/4"		1
3468 1143406	6	1"1/4x3/4"		1
3468 1143407	7	1"1/4x3/4"		1
3468 1143408	8	1"1/4x3/4"		1
3468 1143409	9	1"1/4x3/4"		1
3468 1143410	10	1"1/4x3/4"		1
3468 1143411	11	1"1/4x3/4"		1
3468 1143412	12	1"1/4x3/4"		1

PRE-ASSEMBLED chrome-plated brass manifold complete with:

- Delivery manifold with flowmeters and flow-rate balancing valves
- Return manifold with built-in shut-off valves suitable for thermo-electric actuators
- Intermediate connections, art. 3438
- Fixing brackets, art. 7480
- Connection: 1" - 1 1/4" female-female
- Outlets: 1/2"-3/4" male EUROKONUS
- Flowmeters range: 0-5 l/min
- Centre distance between ports: mm.50



ART. 3581

Code	outlets	size	€	box
3581 11204	4	1"x1/2"		1
3581 11205	5	1"x1/2"		1
3581 11206	6	1"x1/2"		1
3581 11207	7	1"x1/2"		1
3581 11208	8	1"x1/2"		1
3581 11209	9	1"x1/2"		1
3581 11210	10	1"x1/2"		1
3581 11211	11	1"x1/2"		1
3581 11212	12	1"x1/2"		1



Code	outlets	size	€	box
3581 13404	4	1"x3/4"		1
3581 13405	5	1"x3/4"		1
3581 13406	6	1"x3/4"		1
3581 13407	7	1"x3/4"		1
3581 13408	8	1"x3/4"		1
3581 13409	9	1"x3/4"		1
3581 13410	10	1"x3/4"		1
3581 13411	11	1"x3/4"		1
3581 13412	12	1"x3/4"		1
3581 1143404	4	1"1/4x3/4"		1
3581 1143405	5	1"1/4x3/4"		1
3581 1143406	6	1"1/4x3/4"		1
3581 1143407	7	1"1/4x3/4"		1
3581 1143408	8	1"1/4x3/4"		1
3581 1143409	9	1"1/4x3/4"		1
3581 1143410	10	1"1/4x3/4"		1
3581 1143411	11	1"1/4x3/4"		1
3581 1143412	12	1"1/4x3/4"		1

The set point regulating and mixing units are suitable for use in underfloor heating systems for low temperature distribution, and also with combined high and low temperature supplies where high temperature circuits such as radiators are included. They are designed for connection to both flow and return lines with provision for an integral pump.



Art. 3480



Art. 3493

FUNCTION OF ART. 3493

The Set Point Regulation version is suitable for heating systems: this unit can be manually adjusted by turning the handle of the thermostatic mixer to the desired flow temperature value. The pump should always be installed at the mixer outlet, in place of the brass extension piece. The mixed fluid coming out of the pump passes into a fitting (1) on which it is possible to install a safety thermostat with a 1/2" connection. After the connection, the fluid passes through an eccentric (2) which allows to adapt the centre distance of the unit to the one of the manifolds that will be installed. Fluid coming back from the heating circuit passes through a fitting (3) that allows a part of water to re-enter to the boiler, while the remainder is diverted to the thermostatic mixer to mix with the high temperature one.

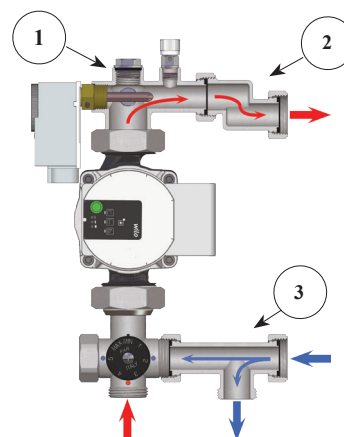

FUNCTION OF ART. 3480

Circulation is as follows: the high temperature water supplied from the boiler reaches the mixer unit through a ball valve (1) and a by-pass diverter connection (2). The connection (2) makes it possible to divert the high temperature water refused by the thermostatic mixer back to the boiler while, the same time, it directing to the boiler the water coming from the manifolds through the return connection (3). The mixer unit is designed to ensure a constant supply of water at the required temperature to the underfloor heating loops - blending in supplies of high temperature water from the boiler as necessary. Water leaves the mixer unit and is pumped to the flow side of the manifolds from whence it is distributed to the individual underfloor heating loops. Water coming back from the loops enters the return side of the manifolds and through the return connection (3) a proportion of the water re-enters the mixing unit restarting circulation while the remainder is diverted back to the boiler.

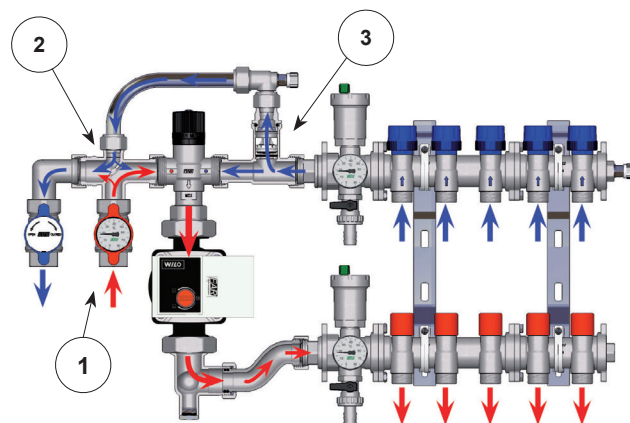

THERMOSTATIC MIXER

The thermostatic mixer is designed to ensure a constant supply of water for the low temperature system. The delivery temperature set-up must be carried out when starting up the system taking the design temperature as a reference. An initial set-up can be achieved based on the relation between the setting on the mixer and the flow water temperature. See below:

POSITION	Min.	1	2	3	4	5	Max
T ±2 [°C]	18	20	22	30	40	50	55



IMMERSION SAFETY THERMOSTAT

The immersion thermostat located on the regulating and mixing unit is designed to shut down the pump, or the boiler, when required. It is a liquid-filled type thermostat. The graduated knob allows the operator to set the maximum temperature value for the system.

Temperature setting range: 10 - 90°C



PUMPS FOR UNDERFLOOR HEATING SYSTEMS

In order to operate correctly, the plastic template on the unit must ALWAYS be replaced with an appropriately sized pump in order to avoid flow resistance in the low temperature circuit. FAR offers the following kind of pump to complement these units:

- **Art.2185 130EA:** **Electronic pump, high efficiency electronic pump, with 130mm centre distance. Variable head: from 1 to 7m.**

The pumps have a 130mm centre distance, 1 1/2" male connections and 230 V supply.

Set point regulating unit for underfloor heating systems.

- Primary side connections (boiler): 1" male
- Secondary side connections (manifold): 1" female with swiveling nut

ART. 3493

Code	size	€	box
3493 1	1"		1

Set point regulating unit complete with thermostatic valve.

- Primary side connections (boiler): 1/2" female
- Secondary side connections (manifold): 1" male with O-ring
- Temperature gauge: 0-80°C
- Manual air vent valve
- Side adjustable drain cock
- Primary side balancing lockshield valve
- Temperature range of thermostatic valve: 10 ÷ 50°C

ART. 3497

Code	size	€	box
3497 1	1"		1

ACCESSORIES:

PUMP

The pump will be supplied pre-assembled

Code	pump	€
2185 130EA	High efficiency electronic pump	

IMMERSION SAFETY THERMOSTAT

Code	Thermostat type	€
7950	immersion	

NB Pumps are supplied only in combination with art. 3493-3497

Set point regulating unit for underfloor heating systems.

- Connection to delivery and return pipelines: 3/4" female

ART. 3480

Code	size	€	box
3480 34	3/4"		1
3480 1	1"		1
3480 114	1 1/4"		1

Pre-assembled unit for underfloor heating systems, complete with set point regulating unit and high temperature distribution manifolds.

- Outlets: 3/4" EUROKONUS
- Fixing brackets, art. 7480

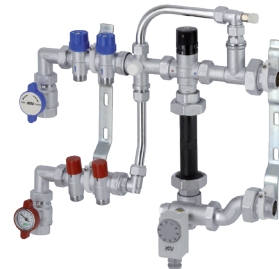
ACCESSORIES:

PUMP

The pump will be supplied pre-assembled

Code	pump	€
2185 130EA	High efficiency electronic pump	

NB Pumps are supplied only in combination with art. 3480-3489

ART. 3489

Code	radiator outlets	size	€	box
3489 13402	2	1"x3/4"		1
3489 13403	3	1"x3/4"		1
3489 13404	4	1"x3/4"		1
3489 13405	5	1"x3/4"		1

12 SET POINT REGULATING UNIT

Pre-assembled unit for underfloor heating systems, complete with:

- Set point regulating unit
- Low temperature delivery manifold with built-in balancing lockshield valves
- Low temperature return manifold with built-in shut-off valves
- Fixing brackets, art. 7480
- Outlets: 3/4" EUROKONUS
- Centre distance between ports: mm.50

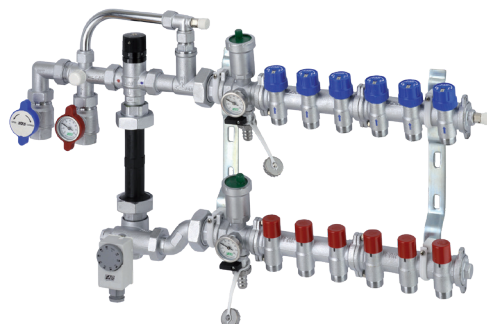

ART. 3485

Code	outlets	size	€	box
3485 13403	3	1"x3/4"		1
3485 13404	4	1"x3/4"		1
3485 13405	5	1"x3/4"		1
3485 13406	6	1"x3/4"		1
3485 13407	7	1"x3/4"		1
3485 13408	8	1"x3/4"		1
3485 13409	9	1"x3/4"		1
3485 13410	10	1"x3/4"		1
3485 13411	11	1"x3/4"		1
3485 13412	12	1"x3/4"		1

ACCESSORIES:



PUMP

The pump will be supplied pre-assembled

Code	pump	€
2185 130EA	High efficiency electronic pump	

NB Pumps are supplied only in combination with art. 3485

Pre-assembled unit for underfloor heating systems, complete with:

- Set point regulating unit
- Low temperature delivery manifold with flowmeters and flow-rate balancing valves
- Low temperature return manifold with built-in shut-off valves
- Fixing brackets, art. 7480
- Outlets: 3/4" EUROKONUS
- Flowmeters range: 0-5 l/min
- Centre distance between ports: mm.50

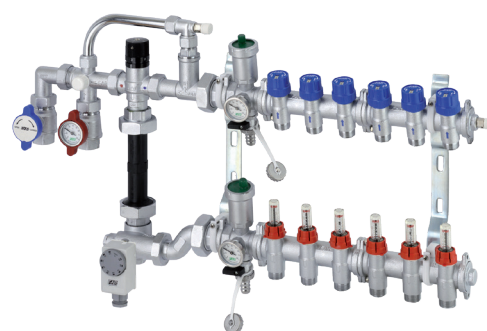

ART. 3584

Code	outlets	size	€	box
3584 13402	2	1"x3/4"		1
3584 13403	3	1"x3/4"		1
3584 13404	4	1"x3/4"		1
3584 13405	5	1"x3/4"		1
3584 13406	6	1"x3/4"		1
3584 13407	7	1"x3/4"		1
3584 13408	8	1"x3/4"		1
3584 13409	9	1"x3/4"		1
3584 13410	10	1"x3/4"		1
3584 13411	11	1"x3/4"		1
3584 13412	12	1"x3/4"		1

ACCESSORIES:



PUMP

The pump will be supplied pre-assembled

Code	pump	€
2185 130EA	High efficiency electronic pump	

NB Pumps are supplied only in combination with art. 3584

Pre-assembled mixed unit for underfloor heating systems complete with:

- Set point regulating unit
 - Low temperature delivery manifold with built-in balancing lockshield valves
 - Low temperature return manifold with built-in shut-off valves
 - High temperature distribution manifolds
 - Fixing brackets, art. 7480
- Outlets: 3/4" EUROKONUS
• Centre distance between ports: mm.50

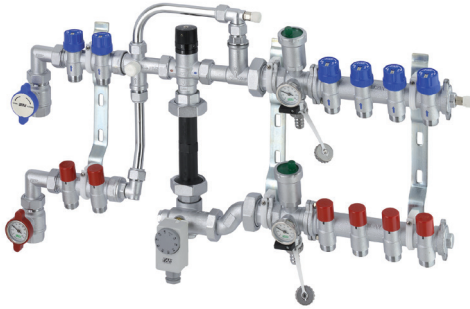
ACCESSORIES:

PUMP

The pump will be supplied pre-assembled

Code	pump	€
2185 130EA	High efficiency electronic pump	

NB Pumps are supplied only in combination with art. 3487

Pre-assembled mixed unit for underfloor heating systems complete with:

- Set point regulating unit
 - Low temperature delivery manifold with flowmeters and flow-rate balancing valves
 - Low temperature return manifold with built-in shut-off valves
 - High temperature distribution manifolds
 - Fixing brackets, art. 7480
- Outlets: 3/4" EUROKONUS
• Flowmeters range: 0-5 l/min
• Centre distance between ports: mm.50

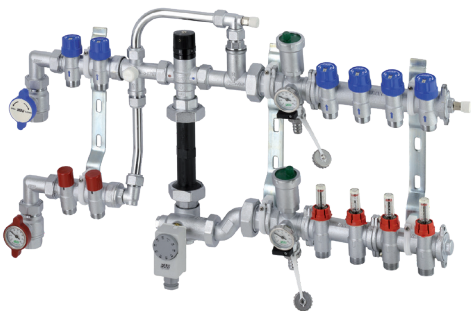
ACCESSORIES:

PUMP

The pump will be supplied pre-assembled

Code	pump	€
2185 130EA	High efficiency electronic pump	

NB Pumps are supplied only in combination with art. 3586

ART. 3487

Code	floor outlets	radiator outlets	size	€	box
3487 1340302	3	2	1"x3/4"		1
3487 1340402	4	2	1"x3/4"		1
3487 1340502	5	2	1"x3/4"		1
3487 1340602	6	2	1"x3/4"		1
3487 1340702	7	2	1"x3/4"		1
3487 1340802	8	2	1"x3/4"		1
3487 1340902	9	2	1"x3/4"		1
3487 1341002	10	2	1"x3/4"		1
3487 1341102	11	2	1"x3/4"		1
3487 1340303	3	3	1"x3/4"		1
3487 1340403	4	3	1"x3/4"		1
3487 1340503	5	3	1"x3/4"		1
3487 1340603	6	3	1"x3/4"		1
3487 1340703	7	3	1"x3/4"		1
3487 1340803	8	3	1"x3/4"		1
3487 1340903	9	3	1"x3/4"		1
3487 1341003	10	3	1"x3/4"		1

ART. 3586

Code	floor outlets	radiator outlets	size	€	box
3586 1340302	3	2	1"x3/4"		1
3586 1340402	4	2	1"x3/4"		1
3586 1340502	5	2	1"x3/4"		1
3586 1340602	6	2	1"x3/4"		1
3586 1340702	7	2	1"x3/4"		1
3586 1340802	8	2	1"x3/4"		1
3586 1340902	9	2	1"x3/4"		1
3586 1341002	10	2	1"x3/4"		1
3586 1341102	11	2	1"x3/4"		1
3586 1340303	3	3	1"x3/4"		1
3586 1340403	4	3	1"x3/4"		1
3586 1340503	5	3	1"x3/4"		1
3586 1340603	6	3	1"x3/4"		1
3586 1340703	7	3	1"x3/4"		1
3586 1340803	8	3	1"x3/4"		1
3586 1340903	9	3	1"x3/4"		1
3586 1341003	10	3	1"x3/4"		1

Modulating/Regulating units for underfloor heating systems are available in HOT only or HOT/COLD versions. They are equipped with a 3-point actuator and a mixing valve. Used in association with a control unit they can manage the flow temperature of an underfloor heating system in accordance with climatic and room conditions.

The MODULATING version is suitable for both heating and cooling systems: the main feature is the facility to manage the plant by modulating the supply temperature via a control unit equipped with an external temperature probe. This version can be also used as a fixed point regulating unit.

The brass template at the outlet of the mixing valve must always to be replaced by a pump.

The unit is equipped with a by-pass between the supply and return sides of the boiler and a safety thermostat.

It is also available with pre-assembled manifolds for distribution of flow for low temperature only, high temperature only, or both.

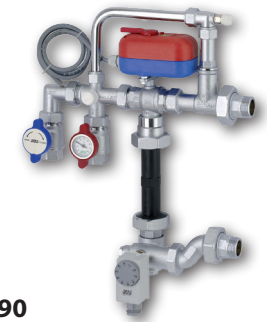

Art. 3490

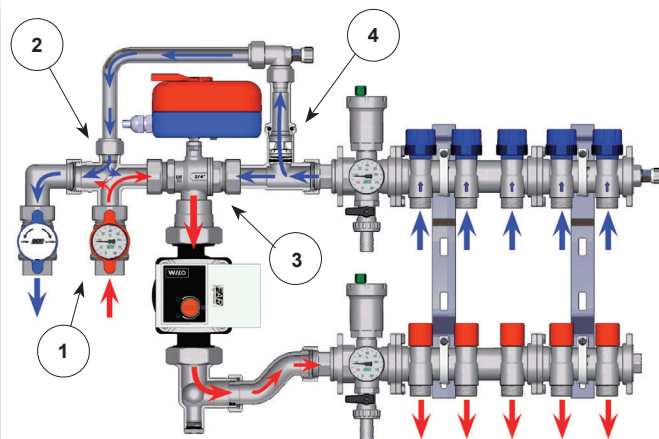

The mixing valve is designed to ensure a constant supply of water, blended to the required temperature, to the underfloor heating loops. Circulation is as follows: water leaves the mixing valve (3), passes through the pump (installed in place of the template) and is pumped to the flow side of the manifolds from whence it is distributed to the individual underfloor heating loops. Water coming back from the loops enters the return side of the manifold and, passing through the return connection (4), re-enters the mixing valve. High temperature water is supplied from the boiler to the mixing valve via a ball valve (1) and diverter connection (2). As it enters the mixing valve an equal volume of lower temperature return water is diverted back to the boiler, passing first through fitting 4 and then through fitting 2, thus automatically keeping the system in balance.



+



HOT ONLY (HEATING)

If you wish to set up to a "hot only" system, you will require both the regulating unit and a control unit, Art. **9611**, comprising:

- HOT Only control unit
- Supply temperature probe
- External temperature probe
- Seat for supply probe



+

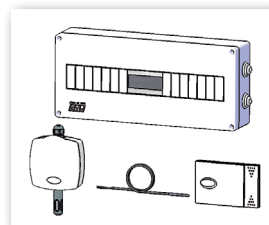

HOT and COLD (HEATING and COOLING)

However, if you need to use a climatic control which operates the circuit in winter and summer, you will also require a control unit, art. **9610**. It comprises:

- HOT - COLD control unit
- Supply temperature probe
- External temperature probe
- Internal temperature + humidity probe
- Seat for supply probe
- Box for controller

PUMPS FOR UNDERFLOOR HEATING SYSTEMS

In order to operate correctly, the brass template on the unit must ALWAYS be replaced with an appropriately sized pump in order to avoid flow resistance in the low temperature circuit. FAR offers the following kind of pump to complement these units:

- **Art.2185 130EA:** **Electronic pump, high efficiency electronic pump, with 130mm centre distance. Variable head: from 1 to 7 m.**

The pumps have a 130mm centre distance, 1"1/2 male connections and 230 V supply.

The pumps are only sold in combination with pre-assembled units.

Modulating regulating unit for underfloor heating systems, complete with 3-point actuator.

- Connection to delivery and return pipelines: 3/4" female



ACCESSORIES:



PUMP

The pump will be supplied pre-assembled

Code	pump	€
2185 130EA	High efficiency electronic pump	



CONTROL UNIT

Code	electronic regulation type	€
9610	hot and cold	
9611	hot only	

NB Pumps and control units are supplied only in combination with art. 3490

Pre-assembled unit for underfloor heating systems, complete with 3- point actuator and high temperature distribution manifolds.

- Outlets: 3/4" EUROKONUS
- Fixing brackets, art. 7480

ART. 3490

Code	size	voltage	€	box
3490 110	1"			1

ACCESSORIES:



PUMP

The pump will be supplied pre-assembled

Code	pump	€
2185 130EA	High efficiency electronic pump	



CONTROL UNIT

Code	electronic regulation type	€
9610	hot and cold	
9611	hot only	

NB Pumps and control units are supplied only in combination with art. 3492



ART. 3492



Code	radiator outlets	size	voltage	€	box
3492 1340210	2	1"x3/4"	230 V		1
3492 1340310	3	1"x3/4"	230 V		1
3492 1340410	4	1"x3/4"	230 V		1
3492 1340510	5	1"x3/4"	230 V		1

2 wired thermo-electric actuator provided with selector. Suitable for installation on thermostatic valves and manifolds.

- Chrome-plated ring with M30x1,5 thread
- Connecting cable length: 75 cm
- Protection level: IP54



- NC = NORMALLY CLOSED
- NA = NORMALLY OPEN

N.B. For installation on thermostatic valves use the chrome-plated adapter, art. 1941.

ART. 1909-1919-1929-1939

Code	voltage	opening time	type	€	box	pack
1909	24 V	180 s	NC		1	100
1919	230 V	180 s	NC		1	100
1929	24 V	180 s	NA		1	100
1939	230 V	180 s	NA		1	100

4 wired thermo-electric actuator with auxiliary micro-switch and selector. Suitable for installation on thermostatic valves and manifolds.

- Chrome-plated ring with M30x1,5 thread
- Connecting cable length: 75 cm
- Protection level: IP54



- NC = NORMALLY CLOSED

N.B. For installation on thermostatic valves use the chrome-plated adapter, art. 1941.

ART. 1914-1924-1913-1923

Code	voltage	opening time	type	€	box	pack
1914	24 V	180 s	NC		1	100
1924	230 V	180 s	NC		1	100
1913	24 V	90 s	NC		1	100
1923	230 V	90 s	NC		1	100

Electronic chrono-thermostat complete with weekly programmable clock and digital display.

- Battery operated (by two AA 1,5V alkaline batteries – not supplied)
- Operating mode: AUTO, COMFORT, ECONOMY and OFF / Frost protection
- Program range: 30 minutes
- Hot/Cold switch
- Wall assembly

ART. 7946

Code	€	box	pack
7946		1	-



Chrome-plated adapter suitable for installation of electric actuators on thermo-electric manifolds.

- M30x1,5 thread

ART. 1942

Code	€	box	pack
1942		1	-



Electronic thermostat for heating and cooling systems.

- Digital display and function keys
- Hot/Cold switch
- Operation: COMFORT, ECONOMY and OFF
- Supplied by two AAA 1,5 V batteries



ART. 7944

Code	€	box	pack
7944		1	-

Electronic chrono-thermostat, with weekly programming for the control of heating and air conditioning systems, with the possibility of remote control via SMS messages.

- Backlit display and function keys
- Weekly programming with three temperature levels
- 2 auxiliary alarm inputs (clean contacts)
- 1 relay auxiliary output (clean contacts) programmable by user
- Backup battery for programming data and clock / calendar maintenance
- Power reserve, to send a power failure message (BLACK-OUT)
- Power supply 230V-50Hz
- Suitable sims: GSM SIM, standard with the GSM 11.12 phase 2+ standard



ART. 7943

Code	€	box	pack
7943		1	-

Electromechanical room thermostat complete with steam sensor.

- Scale: 10÷30° C
- Differential: 0,8 K
- System of limitation and/or locking of T selector
- Protection level: IP20
- Electrical connection with two wires
- Current carrying capacity: 10(2,5)A 250V a.c.



ART. 7948

Code	€	box	pack
7948		1	-

Immersion thermostat.

- Control temperature range: 10÷90°C
- Protection level: IP40
- Sheath: 1/2" (l=50mm)

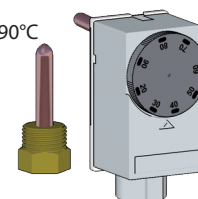

ART. 7950

Code	€	box	pack
7950		1	-

Chrome-plated flowmeter.

- Measuring scale: 1-3,5 litres/min.
- Measuring scale: 2-8 litres/min.
- Connection: 3/4" EUROKONUS

3/4" EUROKONUS connection →



ART. 3428

Code	l/min	€	box
3428 4	1 - 3,5		12
3428 8	2-8		12

Chrome-plated temperature gauge fitting.

- Connection: 3/4" EUROKONUS
- Temperature gauge: 0÷80°C



← 3/4" EUROKONUS connection

ART. 3433

Code	size	€	box
3433 34	3/4"		1

Anti-condensate protection shell made of thermo-formed expanded polyethylene for thermo-electric manifolds.
(Art. 3913-3923-3914-3915-3911-3921-3917-3918)



ART. 9300

Code	outlets	size	€	box
9300 102	2	1"		1
9300 103	3	1"		1
9300 104	4	1"		1
9300 11402	2	1"1/4		1
9300 11403	3	1"1/4		1
9300 11202	2	1"1/2		1
9300 11203	3	1"1/2		1

Anti-condensate protection shell made of thermo-formed expanded polyethylene for intermediate connections (ART. 3438-3445).



ART. 9301

Code	size	€	box
9301 1	1"		1
9301 114	1"1/4		1
9301 112	1"1/2		1

End plug made of velcro for protection shell (ART. 9300) suitable for manifolds with built-in regulating valves (Art. 3923-3915-3921-3918).



ART. 9302

Code	outlets	size	€	box
9302 102	2	1"		1
9302 103	3	1"		1

12 INTERMEDIATE CONNECTIONS

Chrome-plated intermediate connection.

- Size: 3/4" - 1" - 1 1/4" female-female
- Connections: 3/8" - 3/8" - 1/2"



ART. 3430

Code	size	€	box	pack
3430 34	3/4"		10	120
3430 1	1"		10	120
3430 114	1 1/4"		5	40

Chrome-plated intermediate connection.

- Size: 3/4" - 1" female-female
- Connections: 3/8" - 1/2"



ART. 3430TC

Code	size	€	box	pack
3430 34TC	3/4"		10	120
3430 1TC	1"		10	120

Chrome-plated intermediate FLANGED connection. Provided with screws and O-ring for connection.

- Size: 1" female-female
- Connections: 3/8" - 3/8" - 1/2"



ART. 3441

Code	size	€	box	pack
3441 1	1"x3/8"		10	80

Chrome-plated intermediate connection complete with air vent valve, temperature gauge and plug.

- Size: 3/4" - 1" - 1 1/4" - 1 1/2" female-female
- Temperature gauge: 0÷80°C

ART. 3435

Code	size	€	box
3435 34	3/4"		1
3435 1	1"		1
3435 114	1 1/4"		1
3435 112	1 1/2"		1



Chrome-plated intermediate connection complete with air vent valve, thermo-manometer and plug.

- Size: 1" - 1 1/4" - 1 1/2" female-female
- Thermo-manometer: 0÷4 bar - 0÷120°C

ART. 3436

Code	size	€	box
3436 1	1"		1
3436 114	1 1/4"		1
3436 112	1 1/2"		1



Chrome-plated intermediate connection complete with automatic air vent valve, temperature gauge and boiler drain cock.

- Size: 3/4" - 1" - 1 1/4" - 1 1/2" female-female
- Temperature gauge: 0÷80°C

ART. 3438

Code	size	€	box
3438 34	3/4"		1
3438 1	1"		1
3438 114	1 1/4"		1
3438 112	1 1/2"		1



Chrome-plated intermediate connection complete with automatic air vent valve, thermo-manometer and boiler drain cock.

- Size: 1" - 1 1/4" - 1 1/2" female-female
- Thermo-manometer: 0÷4 bar - 0÷120°C

ART. 3442

Code	size	€	box
3442 1	1"		1
3442 114	1 1/4"		1
3442 112	1 1/2"		1



Chrome-plated intermediate FLANGED connection, complete with automatic air vent valve, temperature gauge and plug.

- Provided with screws and O-ring for connection
- Size: 1" female-female
- Temperature gauge: 0÷80°C

ART. 3443

Code	size	€	box
3443 1	1"		1



Chrome-plated intermediate FLANGED connection complete with automatic air vent valve, thermo-manometer and plug.

- Provided with screws and O-ring for connection
- Size: 1" female-female
- Thermo-manometer: 0÷4 bar - 0÷120°C

ART. 3444

Code	size	€	box
3444 1	1"		1



Chrome-plated intermediate FLANGED connection complete with automatic air vent valve, temperature gauge and drain cock.

- Provided with screws and O-ring for connection
- Size: 1" female-female
- Temperature gauge: 0÷80°C

ART. 3445

Code	size	€	box
3445 1	1"		1



Chrome-plated intermediate FLANGED connection complete with automatic air vent valve, thermo-manometer and drain cock.

- Provided with screws and O-ring for connection
- Size: 1" female-female
- Thermo-manometer: 0÷4 bar - 0÷120°C

ART. 3446

Code	size	€	box
3446 1	1"		1



Chrome-plated temperature gauge fitting.

- Size: 1" male-female
- Side connection: 3/8" female



ART. 3431

Code	size	€	box
3431 1	1"		5

Chrome-plated intermediate connection for manifolds, preset for installation of air vent valve, temperature gauge and drain cock.

- Size: 1" male-female



ART. 3440

Code	size	€	box	pack
3440 1	1"		10	80

Chrome-plated temperature gauge fitting.

- Size: 1" male-female
- Temperature gauge: 0÷80°C



ART. 3432

Code	size	€	box
3432 1	1"		1

Chrome-plated terminal connection for manifolds, complete with manual air vent valve and drain cock.

- Connection: 3/4" - 1" - 1"1/4 - 1"1/2 female
- Outlets: 3/8" x 1/2" female

ART. 4070M

Code	size	outlets	€	box
4070 M3438	3/4"	3/8"x1/2"		1
4070 M138	1"	3/8"x1/2"		1
4070 M11438	1"1/4	3/8"x1/2"		1
4070 M11238	1"1/2	3/8"x1/2"		1



Chrome-plated terminal connection for manifolds, complete with automatic air vent valve and drain cock.

- Connection: 3/4" - 1" - 1"1/4 - 1"1/2 female
- Outlets: 3/8" x 1/2" female

ART. 4070

Code	size	outlets	€	box
4070 3438	3/4"	3/8"x1/2"		1
4070 138	1"	3/8"x1/2"		1
4070 11438	1"1/4	3/8"x1/2"		1
4070 11238	1"1/2	3/8"x1/2"		1



Chrome-plated terminal connection for manifolds, complete with manual air vent valve and drain cock.

- Connection: 3/4" - 1" - 1"1/4 - 1"1/2 male
- Outlets: 3/8" x 1/2" female

ART. 4071M

Code	size	outlets	€	box
4071 M3438	3/4"	3/8"x1/2"		1
4071 M138	1"	3/8"x1/2"		1
4071 M11438	1"1/4	3/8"x1/2"		1
4071 M11238	1"1/2	3/8"x1/2"		1



Chrome-plated terminal connection for manifolds, complete with automatic air vent valve and drain cock.

- Connection: 3/4" - 1" - 1"1/4 - 1"1/2 male
- Outlets: 3/8" x 1/2" female

ART. 4071

Code	size	outlets	€	box
4071 3438	3/4"	3/8"x1/2"		1
4071 138	1"	3/8"x1/2"		1
4071 11438	1"1/4	3/8"x1/2"		1
4071 11238	1"1/2	3/8"x1/2"		1



Chrome-plated terminal connection for manifolds. Double radial connection.

- Connection: 3/4" - 1" - 1"1/4 - 1"1/2 female
- Outlets: 1/2" x 1/2" female
3/8" x 1/2" female

ART. 4060

Code	size	outlets	€	box	pack
4060 3438	3/4"	3/8"x1/2"		25	250
4060 3412	3/4"	1/2"x1/2"		25	250
4060 138	1"	3/8"x1/2"		25	250
4060 112	1"	1/2"x1/2"		25	250
4060 11438	1"1/4	3/8"x1/2"		20	200
4060 11412	1"1/4	1/2"x1/2"		20	200
4060 11238	1"1/2	3/8"x1/2"		1	-
4060 11212	1"1/2	1/2"x1/2"		1	-



Chrome-plated terminal connection for manifolds. Double radial connection.

- Connection: 3/4" - 1" - 1"1/4 - 1"1/2 male
- Outlets: 1/2" x 1/2" female
3/8" x 1/2" female

ART. 4061

Code	size	outlets	€	box	pack
4061 3438	3/4"	3/8"x1/2"		25	250
4061 3412	3/4"	1/2"x1/2"		25	250
4061 138	1"	3/8"x1/2"		25	250
4061 112	1"	1/2"x1/2"		25	250
4061 11438	1"1/4	3/8"x1/2"		20	200
4061 11412	1"1/4	1/2"x1/2"		20	200
4061 11238	1"1/2	3/8"x1/2"		1	-
4061 11212	1"1/2	1/2"x1/2"		1	-



Chrome-plated boiler drain cock.

ART. 3439

Code	size	€	box
3439 12	1/2"		10



Brass boiler drain cock.

ART. 3447

Code	size	€	box
3447 12	1/2"		10

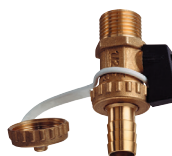

FLAT FACED CONNECTION

This kind of connection has a flat base on the thread head, which provides support for a flat gasket. It is available in 1/2" and 3/4" sizes.

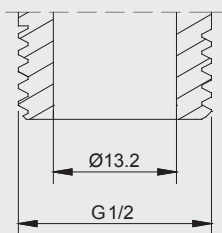

1/2" FLAT FACED CONNECTION

Available for the following manifolds:
 3175-3225-3275-3475-3525-3575-3625-3675-3725-3821-3822-3823-3824-3818-3819-3859-3860-3869-3870-3872-3873

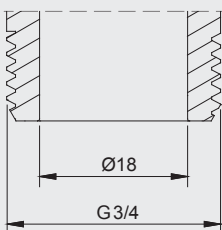

3/4" FLAT FACED CONNECTION

Available for the following manifolds:
 3625-3675-3725-3821-3822-3824-3860-3870-3873

IRON FEMALE CONNECTION

It is the normal female connection for iron pipe with BSP thread. It is available with 1/2" size.

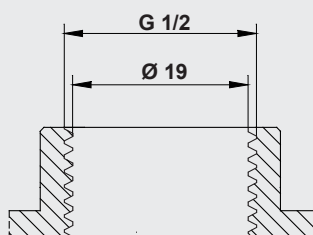

1/2" IRON FEMALE CONNECTION

Available for the following manifolds:
 3150-3200-3250-3450-3500-3550-3600-3650-3700-3710

OVERVIEW OF FLAT FACED CONNECTION

For connection of multilayer pipes on flat faced ports, it is possible to use pressfittings with swiveling nut.

The available fittings (ART. 5919) are shown on page 251.

The seal between fitting and manifold is guaranteed by a flat EPDM gasket.

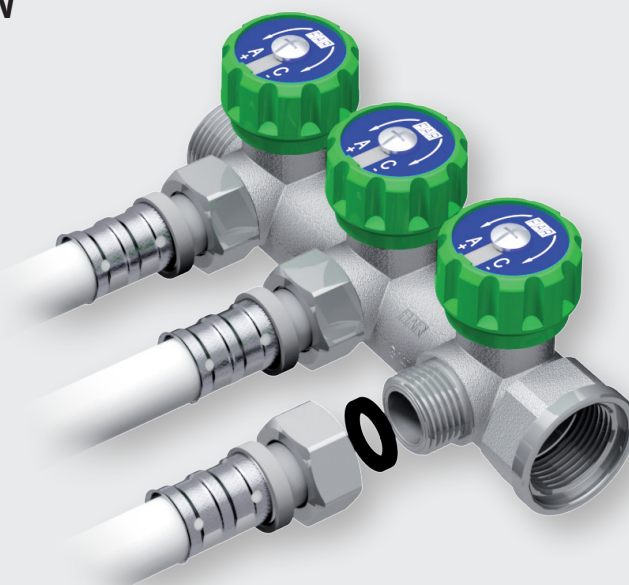

MULTIFAR - 2 port chrome-plated modular manifold for both domestic services and heating systems. Complete with manual controls. Each port is equipped with 2 silk-screen printed discs for circuit identification.

- Body made of CB753S brass
- Side connections: 3/4" - 1" male-female
- Outlets: 1/2"-3/4" male
- Centre distance between ports: 45 mm



NB Insulation on page 177

ART. 3821

Code	outlets	size	€	box	pack
3821 3412TP	1/2" FLAT FACED	3/4"		1	25
3821 3412EU	1/2" EUROKONUS	3/4"		1	25
3821 112TP	1/2" FLAT FACED	1"		1	25
3821 112EU	1/2" EUROKONUS	1"		1	25
3821 134TP	3/4" FLAT FACED	1"		1	25
3821 134EU	3/4" EUROKONUS	1"		1	25

MULTIFAR - 4 port chrome-plated modular manifold for both domestic services and heating systems. Complete with manual controls. Each port is equipped with 2 silk-screen printed discs for circuit identification.

- Body made of CB753S brass
- Side connections: 3/4" - 1" male-female
- Outlets: 1/2"-3/4" male
- Centre distance between ports: 45 mm

NB Insulation on page 177

ART. 3824

Code	outlets	size	€	box	pack
3824 3412TP	1/2" FLAT FACED	3/4"		1	25
3824 3412EU	1/2" EUROKONUS	3/4"		1	25
3824 112TP	1/2" FLAT FACED	1"		1	25
3824 112EU	1/2" EUROKONUS	1"		1	25
3824 134TP	3/4" FLAT FACED	1"		1	25
3824 134EU	3/4" EUROKONUS	1"		1	25

MULTIFAR - 2 port chrome-plated modular manifold for both domestic services and heating systems. Complete with manual controls. Each port is equipped with 2 silk-screen printed discs for circuit identification.

- Body made of CB753S brass
- Side connection: 3/4" female
- Outlets: 1/2" male
- Centre distance between ports: 45 mm
- **WHILE STOCKS LAST**

ART. 3818

Code	outlets	size	€	box	pack
3818 3412TP	1/2" FLAT FACED	3/4"		1	25
3818 3412EU	1/2" EUROKONUS	3/4"		1	25

MULTIFAR - 3 port chrome-plated modular manifold for both domestic services and heating systems. Complete with manual controls. Each port is equipped with 2 silk-screen printed discs for circuit identification.

- Body made of CB753S brass
- Side connections: 3/4" - 1" male-female
- Outlets: 1/2"-3/4" male
- Centre distance between ports: 45 mm



NB Insulation on page 177

ART. 3822

Code	outlets	size	€	box	pack
3822 3412TP	1/2" FLAT FACED	3/4"		1	25
3822 3412EU	1/2" EUROKONUS	3/4"		1	25
3822 112TP	1/2" FLAT FACED	1"		1	25
3822 112EU	1/2" EUROKONUS	1"		1	25
3822 134TP	3/4" FLAT FACED	1"		1	25
3822 134EU	3/4" EUROKONUS	1"		1	25

MULTIFAR - 3 port chrome-plated modular manifold for both domestic services and heating systems. Complete with manual controls. Each port is equipped with 2 silk-screen printed discs for circuit identification.

- Body made of CB753S brass
- Side connection: 3/4" female
- Outlets: 1/2" male
- Centre distance between ports: 45 mm
- **WHILE STOCKS LAST**

ART. 3819

Code	outlets	size	€	box	pack
3819 3412TP	1/2" FLAT FACED	3/4"		1	25
3819 3412EU	1/2" EUROKONUS	3/4"		1	25

12 MULTIFAR MANIFOLDS AND ACCESSORIES

MULTIFAR - Chrome-plated modular manifold for both domestic services and heating systems. Complete with regulating valves.

- Body made of CB753S brass
- Side connections: 3/4" - 1" male-female
- Outlets: 1/2"-3/4" male
- Centre distance between ports: 45 mm



ART. 3860-3870-3873

Code	outlets	size	€	box	pack
3860 3412TP	2 - 1/2" FLAT FACED	3/4"		1	25
3860 3412EU	2 - 1/2" EUROKONUS	3/4"		1	25
3860 112TP	2 - 1/2" FLAT FACED	1"		1	25
3860 112EU	2 - 1/2" EUROKONUS	1"		1	25
3860 134TP	2 - 3/4" FLAT FACED	1"		1	25
3860 134EU	2 - 3/4" EUROKONUS	1"		1	25
3870 3412TP	3 - 1/2" FLAT FACED	3/4"		1	25
3870 3412EU	3 - 1/2" EUROKONUS	3/4"		1	25
3870 112TP	3 - 1/2" FLAT FACED	1"		1	25
3870 112EU	3 - 1/2" EUROKONUS	1"		1	25
3870 134TP	3 - 3/4" FLAT FACED	1"		1	25
3870 134EU	3 - 3/4" EUROKONUS	1"		1	25
3873 3412TP	4 - 1/2" FLAT FACED	3/4"		1	25
3873 3412EU	4 - 1/2" EUROKONUS	3/4"		1	25
3873 112TP	4 - 1/2" FLAT FACED	1"		1	25
3873 112EU	4 - 1/2" EUROKONUS	1"		1	25
3873 134TP	4 - 3/4" FLAT FACED	1"		1	25
3873 134EU	4 - 3/4" EUROKONUS	1"		1	25

MULTIFAR - Chrome-plated modular manifold for both domestic services and heating systems. Complete with regulating valves.

- Body made of CB753S brass
- Side connection: 3/4" female
- Outlets: 1/2" male
- Centre distance between ports: 45 mm
- **WHILE STOCKS LAST**



ART. 3859-3869

Code	outlets	size	€	box	pack
3859 3412TP	2 - 1/2" FLAT FACED	3/4"		1	25
3859 3412EU	2 - 1/2" EUROKONUS	3/4"		1	25
3869 3412TP	3 - 1/2" FLAT FACED	3/4"		1	25
3869 3412EU	3 - 1/2" EUROKONUS	3/4"		1	25



ART. 3879



Code	outlets	size	€	box	pack
3879 341202EU	2 - 1/2"	3/4"		1	25
3879 341203EU	3 - 1/2"	3/4"		1	25
3879 341204EU	4 - 1/2"	3/4"		1	25
3879 11202EU	2 - 1/2"	1"		1	25
3879 11203EU	3 - 1/2"	1"		1	25
3879 11204EU	4 - 1/2"	1"		1	25
3879 13402EU	2 - 3/4"	1"		1	25
3879 13403EU	3 - 3/4"	1"		1	25
3879 13404EU	4 - 3/4"	1"		1	25

Chrome-plated manifold.

- Body made of CB753S brass
- Side connection: 3/4"-1" female
- Outlets: 1/2" female
- Centre distance between ports: 36 mm



Chrome-plated modular manifold.

- Body made of CB753S brass
- Side connections: 3/4"-1" male-female
- Outlets: 1/2" female
- Centre distance between ports: 36 mm



ART. 3150-3200-3250



Code	outlets	size	€	box	pack
3150 1	2	1"		12	120
3200 34	3	3/4"		10	100
3200 1	3	1"		8	80
3250 34	4	3/4"		8	80
3250 1	4	1"		6	60

ART. 3450-3500-3550



Code	outlets	size	€	box	pack
3450 1	2	1"		10	100
3500 34	3	3/4"		9	90
3500 1	3	1"		7	70
3550 34	4	3/4"		8	80
3550 1	4	1"		6	60

Chrome-plated modular manifold.

- Body made of CB753S brass
- Side connections: 3/4"-1"-1"1/4 male - female
- Outlets: 1/2" female
- Centre distance between ports: 50 mm



ART. 3600-3650-3700



Code	outlets	size	€	box	pack
3600 34	2	3/4"		12	120
3600 1	2	1"		8	80
3600 114	2	1"1/4		8	80
3650 34	3	3/4"		8	80
3650 1	3	1"		6	60
3650 114	3	1"1/4		6	60
3700 34	4	3/4"		6	60
3700 1	4	1"		4	40
3700 114	4	1"1/4		4	40

Chrome-plated manifold.

- Body made of CB753S brass
- Side connection: 3/4"-1" female
- Outlets: 1/2" male
- Centre distance between ports: 36 mm
- AVAILABLE ONLY WITH FLAT FACED CONNECTION



ART. 3175-3225-3275

Code	outlets	size	€	box	pack
3175 34	2	3/4"		14	140
3175 1	2	1"		12	120
3225 34	3	3/4"		10	100
3225 1	3	1"		8	80
3275 34	4	3/4"		8	80
3275 1	4	1"		6	60

Chrome-plated modular manifold.

- Body made of CB753S brass
- Side connections: 3/4" male-female
- Outlets: 1/2" male
- Side connections: 1"-1 1/4" male-female
- Outlets: 1/2"-3/4" male
- Centre distance between ports: 50 mm



ART. 3625

Code	outlets	size	€	box	pack
3625 3412TP	2 - 1/2" FLAT FACED	3/4"		12	120
3625 3412EU	2 - 1/2" EUROKONUS	3/4"		12	120
3625 112TP	2 - 1/2" FLAT FACED	1"		8	80
3625 112EU	2 - 1/2" EUROKONUS	1"		8	80
3625 134TP	2 - 3/4" FLAT FACED	1"		8	80
3625 134EU	2 - 3/4" EUROKONUS	1"		8	80
3625 11412TP	2 - 1/2" FLAT FACED	1 1/4"		8	80
3625 11412EU	2 - 1/2" EUROKONUS	1 1/4"		8	80
3625 11434TP	2 - 3/4" FLAT FACED	1 1/4"		8	80
3625 11434EU	2 - 3/4" EUROKONUS	1 1/4"		8	80

Chrome-plated modular manifold.

- Body made of CB753S brass
- Side connections: 3/4"-1" male-female
- Outlets: 1/2" male
- Centre distance between ports: 36 mm



ART. 3475-3525-3575

Code	outlets	size	€	box	pack
3475 34TP	2 - 1/2" FLAT FACED	3/4"		12	120
3475 34EU	2 - 1/2" EUROKONUS	3/4"		12	120
3475 1TP	2 - 1/2" FLAT FACED	1"		10	100
3475 1EU	2 - 1/2" EUROKONUS	1"		10	100
3525 34TP	3 - 1/2" FLAT FACED	3/4"		9	90
3525 34EU	3 - 1/2" EUROKONUS	3/4"		9	90
3525 1TP	3 - 1/2" FLAT FACED	1"		7	70
3525 1EU	3 - 1/2" EUROKONUS	1"		7	70
3575 34TP	4 - 1/2" FLAT FACED	3/4"		8	80
3575 34EU	4 - 1/2" EUROKONUS	3/4"		8	80
3575 1TP	4 - 1/2" FLAT FACED	1"		6	60
3575 1EU	4 - 1/2" EUROKONUS	1"		6	60

ART. 3675-3725

Code	outlets	size	€	box	pack
3675 3412TP	3 - 1/2" FLAT FACED	3/4"		8	80
3675 3412EU	3 - 1/2" EUROKONUS	3/4"		8	80
3675 112TP	3 - 1/2" FLAT FACED	1"		6	60
3675 112EU	3 - 1/2" EUROKONUS	1"		6	60
3675 134TP	3 - 3/4" FLAT FACED	1"		6	60
3675 134EU	3 - 3/4" EUROKONUS	1"		6	60
3675 11412TP	3 - 1/2" FLAT FACED	1 1/4"		6	60
3675 11412EU	3 - 1/2" EUROKONUS	1 1/4"		6	60
3675 11434TP	3 - 3/4" FLAT FACED	1 1/4"		6	60
3675 11434EU	3 - 3/4" EUROKONUS	1 1/4"		6	60
3725 3412TP	4 - 1/2" FLAT FACED	3/4"		6	60
3725 3412EU	4 - 1/2" EUROKONUS	3/4"		6	60
3725 112TP	4 - 1/2" FLAT FACED	1"		4	40
3725 112EU	4 - 1/2" EUROKONUS	1"		4	40
3725 134TP	4 - 3/4" FLAT FACED	1"		4	40
3725 134EU	4 - 3/4" EUROKONUS	1"		4	40
3725 11412TP	4 - 1/2" FLAT FACED	1 1/4"		4	40
3725 11412EU	4 - 1/2" EUROKONUS	1 1/4"		4	40
3725 11434TP	4 - 3/4" FLAT FACED	1 1/4"		4	40
3725 11434EU	4 - 3/4" EUROKONUS	1 1/4"		4	40

Chrome-plated straight terminal blanking reduction for modular manifolds complete with gasket.

- Connection: 3/4"-1" female
- Outlets: 1/4"-3/8"-1/2"- female
- Connection: 1"1/4 female
- Outlets: 1/4"-3/8"-1/2"-3/4" female

ART. 4000

Code	size	€	box	pack
4000 3414	3/4"x1/4"		30	300
4000 3438	3/4"x3/8"		30	300
4000 3412	3/4"x1/2"		30	300
4000 114	1"x1/4"		30	300
4000 138	1"x3/8"		30	300
4000 112	1"x1/2"		30	300
4000 11414	1"1/4x1/4"		25	250
4000 11438	1"1/4x3/8"		25	250
4000 11412	1"1/4x1/2"		25	250
4000 11434	1"1/4x3/4"		25	250



Chrome-plated angled terminal blanking reduction for modular manifolds.

- Connection: 3/4"-1"- 1"1/4 female
- Outlets: 1/4"-3/8"-1/2" female

ART. 4050

Code	size	€	box	pack
4050 3414	3/4"x1/4"		30	240
4050 3438	3/4"x3/8"		30	240
4050 3412	3/4"x1/2"		30	240
4050 114	1"x1/4"		30	180
4050 138	1"x3/8"		30	180
4050 112	1"x1/2"		30	180
4050 11438	1"1/4x3/8"		30	180
4050 11412	1"1/4x1/2"		30	180



Chrome-plated blind cap complete with gasket.

ART. 4100

Code	size	€	box	pack
4100 12	1/2"		50	500
4100 34	3/4"		40	400
4100 1	1"		30	300
4100 114	1"1/4		30	300
4100 112	1"1/2		15	150
4100 2	2"		10	100



Chrome-plated male plug for manifold outlets.

ART. 4125

Code	size	€	box	pack
4125 12	1/2"		30	-



Chrome-plated terminal blanking plug with O-ring seal for manifolds.

ART. 4150

Code	size	€	box	pack
4150 34	3/4"		25	250
4150 1	1"		25	250
4150 114	1"1/4		25	250
4150 112	1"1/2		10	100
4150 2	2"		10	100



Chrome-plated terminal blanking reduction with O-ring seal for manifolds with connection for air vent valve.

ART. 4200

Code	size	€	box	pack
4200 3414	3/4"x1/4"		25	250
4200 3438	3/4"x3/8"		25	250
4200 3412	3/4"x1/2"		25	250
4200 114	1"x1/4"		25	250
4200 138	1"x3/8"		25	250
4200 112	1"x1/2"		25	250
4200 134	1"x3/4"		25	250
4200 11412	1"1/4x1/2"		25	250
4200 11434	1"1/4x3/4"		25	250
4200 1141	1"1/4x1"		25	250
4200 1121	1"1/2x1"		10	100
4200 21	2"x1"		10	100



End closing plug for flanged manifolds.



ART. 4310

Code	size	€	box
4310 1	1"		30

12 EXTENSIBLE JOINT WITH EUROKONUS CONNECTIONS

SIMPLYFAR - Chrome plated extensible and repair joint.

- Body made of brass CW614N
- 3/4" EUROKONUS connections
- EPDM double sealing O-ring
- Suitable for underfloor installation

SIMPLYFAR

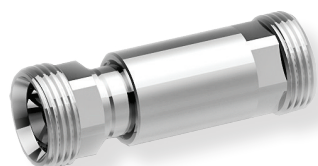

ART. 8881



Code	extension	size	€	box	pack
8881 3034EU	66-95 mm	3/4"		5	-

The extensible FAR joint with EUROKONUS connections can be used as a repair joint in case of leaks or damaged pipes and, if needed, as an extension with a maximum expansion of 95 mm.

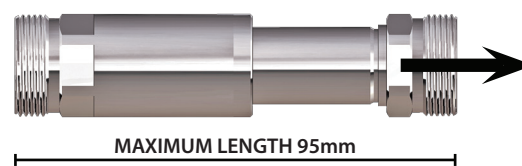

INSTALLATION

<p>1 Find the leakage on the pipe</p>	<p>2 Cut the portion of damaged pipe taking the following dimensions as a reference</p> <p>PLASTIC AND MULTILAYER PIPE 94mm</p> <p>COPPER PIPE 66mm</p>
<p>3 Insert the adapters and place the joint.</p>	<p>4 Extend the joint until it's completely screwed in and connect it to the pipe</p>

Chrome-plated fitting.

- Fitting body in CW617N stamped brass
- Male eurokonus connection

ART. 5800



Code	size	€	box	pack
5800 12	1/2"		50	500
5800 34	3/4"		50	500

Chrome-plated fitting.

- Fitting body in CW617N stamped brass
- Male eurokonus connection-female connection

ART. 5805



Code	size	€	box	pack
5805 12	1/2"		50	500
5805 34	3/4"		50	500

Chrome-plated elbow.

- Fitting body in CW617N stamped brass
- Male eurokonus connection

ART. 5810



Code	size	€	box	pack
5810 12	1/2"		25	250
5810 34	3/4"		25	250

Chrome-plated elbow.

- Fitting body in CW617N stamped brass
- Male eurokonus connection-female connection

ART. 5815



Code	size	€	box	pack
5815 12	1/2"		25	250
5815 34	3/4"		25	250

Chrome-plated T connection.

- Fitting body in CW617N stamped brass
- 1/2"x1/2"x1/2" male eurokonus connections

ART. 5820



Code	size	€	box	pack
5820 12	1/2"		25	250

Chrome-plated T connection.

- Fitting body in CW617N stamped brass
- 1/2"x1/2" X1/2" male-female eurokonus connections

ART. 5825



Code	size	€	box	pack
5825 12	1/2"		25	250

Chrome-plated wall-mounted connection.

- Fitting body in CW617N stamped brass
- 1/2" male eurokonus connection

ART. 5830



Code	size	€	box	pack
5830 12	1/2"		25	250

Chrome-plated bent connection for domestic systems.

- Fitting body in CW617N stamped brass
- 1/2" male eurokonus connection

ART. 5835



Code	size	€	box	pack
5835 12	1/2"		25	250

Chrome-plated flow-through straight connection.

- Fitting body in CW617N stamped brass
- 1/2"x1/2" male eurokonus connections

ART. 5840



Code	size	€	box	pack
5840 12	1/2"		25	250

Chrome-plated flow-through "L" connection.

- Fitting body in CW617N stamped brass
- 1/2"x1/2" male eurokonus connections

ART. 5845



Code	size	€	box	pack
5845 12	1/2"		25	250

Chrome-plated terminal connection.

- Fitting body in CW617N stamped brass
- 1/2" male eurokonus connection

ART. 5850



Code	size	€	box	pack
5850 12	1/2"		25	250

12 ADAPTERS AND SEALING KIT

Adapter for plastic pipes complete with chrome-plated nut. Suitable for all our products with EUROKONUS connection.

Adapter for multilayer pipes complete with chrome-plated nut. Suitable for all our products with EUROKONUS connection.



ART. 6075

Code	nut	size	€	box	pack
6075 65851	1/2"	14x2		50	250
6075 581007	1/2"	16x2		50	250
6075 58845	1/2"	16x2,2		50	250
6075 65847	3/4"	14x2		50	250
6075 823999	3/4"	16x2		50	250
6075 823855	3/4"	16x2,2		50	250
6075 150283	3/4"	17x2		50	250
6075 825848	3/4"	20x2		50	250
6075 825846	3/4"	20x2,8		50	250
6075 288287	3/4"	21x2,4		50	250
6075 288286	3/4"	21x2,5		50	250
6075 288849	3/4"	21x3,5		50	250



ART. 6076

Code	nut	size	€	box	pack
6076 65803	1/2"	14x2		50	250
6076 58802	1/2"	16x2		50	250
6076 65850	3/4"	14x2		50	250
6076 823824	3/4"	16x2		50	250
6076 150875	3/4"	17x2		50	250
6076 44839	3/4"	18x2		50	250
6076 825826	3/4"	20x2		50	250
6076 825844	3/4"	20x2,5		50	250
6076 2881135	3/4"	21x3,5		50	250

Sealing compression KIT in rubber for copper pipe.

- brass pipe guide washer
- rubber gasket
- brass ring
- 3/4" chrome-plated nut



ART. 8420

Code	nut	size	€	box	pack
8420 15	3/4"	15		50	500

Sealing compression KIT in rubber for copper pipe.

- rubber gasket
- brass ring
- 3/4" chrome-plated nut



ART. 8421

Code	nut	size	€	box	pack
8421 18	3/4"	18		50	500

EUROKONUS CONNECTION

Eurokonus connections are available for 1/2" and 3/4" sizes.

They permit connection of multilayer, plastic and copper pipes to manifolds by means of adapters:

- Art. 6075 for plastic pipe
- Art. 6076 for multilayer pipe
- Art. 8420 and 8421 for copper pipe

1/2" EUROKONUS CONNECTION

Available for the following manifolds:

3466-3467-3468-3475-3525-3575-3625-3675-3725-3580-3581-3818-3819-3821-3822-3823-3824-3859-3860-3869-3870-3872-3873-3879-3911-3921-3928-3980-3981

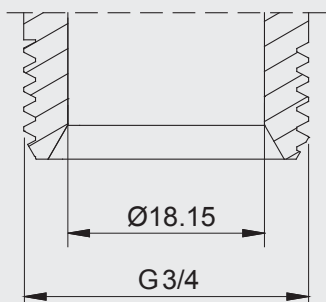

3/4" EUROKONUS CONNECTION

Available for the following manifolds:

3466-3467-3468-3469-3470-3471-3485-3486-3487-3488-3489-3492-3580-3581-3582-3583-3584-3585-3586-3587-3588-3589-3590-3591-3625-3675-3725-3821-3822-3824-3860-3870-3873-3879-3911-3917-3918-3919-3921-3928-3980-3981-3982-3983

